

Reset & reprogram the Roller blind motor

Step 1 – Initiate Reset

Locate the motor reset button located on the motor head.

PRESS & HOLD the button until the blind jogs three times (approx. 10 secs)

– all settings are deleted and the motor has been reset.

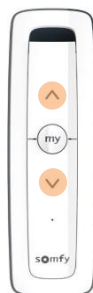
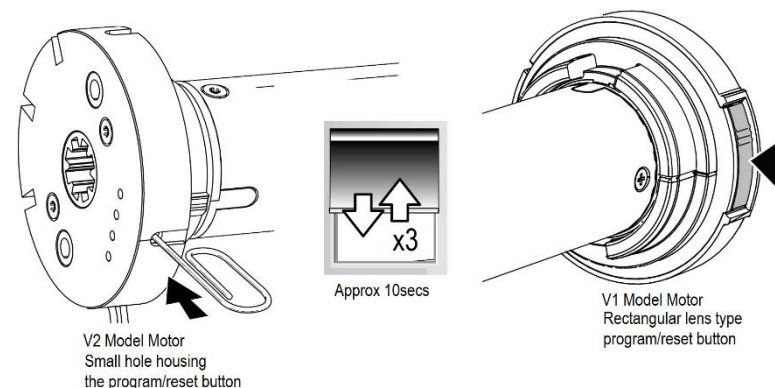

STEP 2: Initiate programming

Press both and simultaneously then release - the blind jogs. *A jog is a brief up and down motion.* You can now operate the blind, but it will only move when the or buttons are held down.



STEP 3: Check directions

Press the button. While pressing the blind should travel down. If the blind goes up, change direction by pressing and holding the button until the blind jogs (approx 5 secs). Press the button to check the direction has reversed.

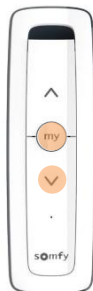

STEP 4: Setting the UPPER stopping position

Adjust the blind to the upper stop position. Press both and simultaneously, then release - the blind will start to lower (if nothing happens, repeat the process until the blind starts to lower). Stop the blind at the lower stopping position and fine tune to the exact point with or .

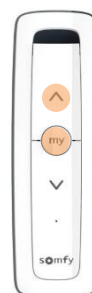

STEP 5: Setting the LOWER stopping position

Press both and simultaneously, then release. The blind will move up and stop at the upper stop position previously set (if nothing happens, repeat the process until the blind starts to move up).

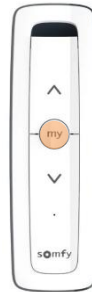

STEP 6: Confirm the stopping positions

Once the blind has stopped at the upper stop position, press and hold until the blind jogs to confirm the stop positions have been recorded (approx 5 secs).



STEP 7: Set user mode

Press and release the programming button on the back of the control - the blind jogs. The blind is now in User Mode and the control has been recorded to the motor. Double check the stop positions as a precaution.

The reset and programming procedure is complete.