

## Order Contents

- 1** Check the headrail specification is correct based on the width:  
Up to 1M: 2 brackets, >1M to 2M: 3 brackets, >2M: 4 brackets (including screws & plugs)  
43cm to 65cm: 2 spools, >65cm to 90cm: 3 spools, >90cm to 140cm: 4 spools  
>140cm to 180cm: 5 spools, >180cm to 210cm: 6 spools, >210cm to 240cm: 7 spools  
The power supply ordered (if applicable) is correct  
The control ordered (if applicable) is correct  
Any optional extras ordered (if applicable) are correct

## Fitting Tools



## Secure the roman fabric panel to the headrail

- 2** Release all of the cords so the hang free and secure the fabric panel to the velcro strip on the front of the headrail.  
We recommend that you lay the fabric panel flat at this stage.

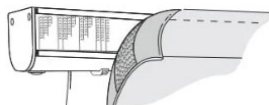

## Stop Collar Adjustment

There are two stop collars located at either side of the motor to prevent the drive shaft from coming away from the motor output shaft - these stop collars are fitted up against one of the cord spools and secured in place to prevent any lateral movement of the drive shaft. When adjusting the cord spools to line up the cord positions for the roman blind fabric panel, you must loosen the stop collar screw to allow lateral movement of the cord spool, then resecure the stop collar up against the adjacent cord spool to ensure the drive shaft will remain secured in the motor.

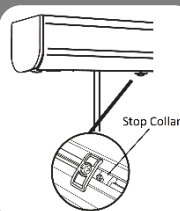

## Adjust the cord spool positions

- 3** It is likely the cord positions will require adjusting to align them as required with the roman fabric panel.

Loosen the cord spool clamps as required, which will allow lateral movement of the cord positions – remember to loosen the stop collar and secure it back in place once the cord spools are in the correct position.

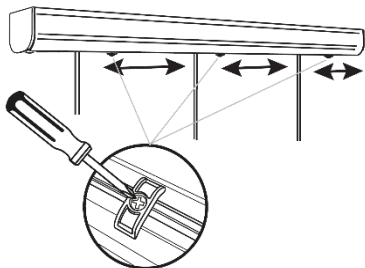

## Fit the cords to the fabric panel

- 4** With the cord positions aligned, ensure the cord spool clamps have been retightened and the stop collars have been secured up to the adjacent cord spool to prevent lateral movement of the drive shaft.

Thread the cords through the panel pocket tape or cord rings, then secure at the bottom with a cord clamp or similar.

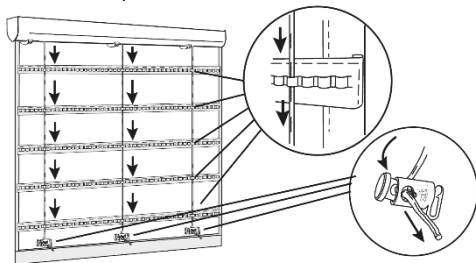

## Adjust the cord spool positions

- 5** Trim any excess cord at the bottom leaving around 100mm of loose cord at the point of the clamp or knot.  
Ensure all cord lengths are equal so the fabric panel will raise and lower level.

## 12Vdc Power Supply

- 6** We recommend you fit the battery tube/pack or solar pack first if selected as the power supply. Mounting clips for the battery/solar tube/pack are supplied with the respective power supply. Refer to the instructions supplied with the li-ion rechargeable battery pack or solar pack for further installation instructions.

## Bracket Fitting

- 7 A** - The brackets are designed to allow for face or top fixing to the window frame, wall or ceiling.
- Ensure the brackets are positioned away from window /door handles or any other obstructions to allow the blind to operate smoothly.
- A bracket should sit either side of the rail, 110mm away from the end with remaining brackets equally distributed along the width.

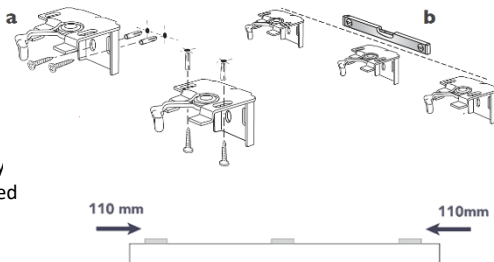

**B** - Mark the fixing positions with a pencil making sure they are level and in line - check with a spirit level.

Drill each screw position and secure the brackets into place using screws and plugs provided.

**Use appropriate alternate fixings if securing into a surface the fixings supplied are not suitable for.**

## Fitting The Headrail

- 8 A** - With the brackets in the unlocked position, locate the front lip of the headrail onto the front of the bracket. Angle the headrail back towards the bracket and hold in position.

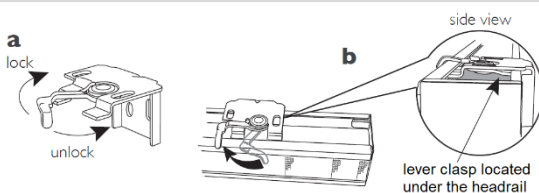

**B** - Secure the headrail in place by sliding the bracket lever into the locked position.

## Power Up The Motor

- 9** Connect your Somfy 12Vdc power supply to the motor supply cable.
- Tidy away any loose supply cable that might interfere with the blind during operation.
- The blind will briefly jog indicating the motor is powered up.

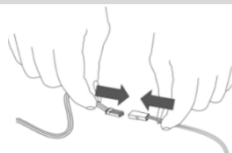

## Motor Programming

- 10** The blind can only be operated once the motor is correctly programmed and the control paired.
- Use your Somfy RTS control to program the motor:

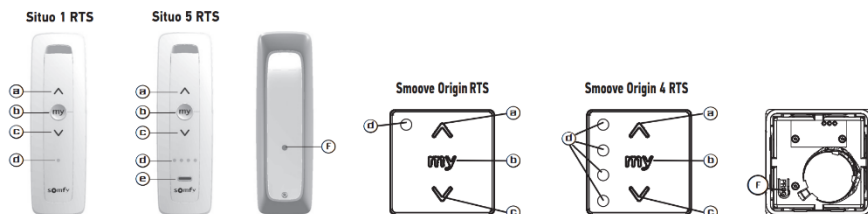

a) Up button   b) 'my' & stop button   c) Down button   d) LED/channel   e) Channel selector   f) Program button

## Initiate the pairing process

- 11** If using a Somfy multi-channel control, ensure the desired channel is selected prior to starting this process.



**BRIEFLY PRESS & RELEASE** the Up & Down buttons on the control:  
*The motor will jog briefly.*



## Checking/correcting the blind direction

- 12** **BRIEFLY PRESS & RELEASE** the Down button on the control.  
If the blind operates down, the direction is correct – go to the next step.  
If the blind operates up, **PRESS & HOLD** the 'my' button until the blind jogs to reverse the direction.

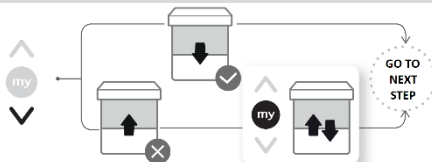

## Recording the upper & lower stop positions

- 13**
1. Use the control to adjust the blind to the upper stop position.
  2. **BRIEFLY PRESS & RELEASE** the 'my' & Down buttons on the control – the blind will operate down.
  3. **BRIEFLY PRESS** the 'my' button once the blind reaches the lower stop position.  
*Fine tune to the exact lower stop position if required with the Up & Down buttons.*
  4. **BRIEFLY PRESS & RELEASE** the 'my' & Up buttons on the control – the blind will operate up and stop at the upper stop position previously set.
  5. Record the stopping positions by **PRESSING & HOLDING** the 'my' button until the blind jogs.

## Pairing the control & completing the programming process

- 14** **BRIEFLY PRESS & RELEASE** the program button on the control – the blind will jog. The programming process is complete and the blind motor is programmed.



## Disabling The 'Tilt-Mode'

- 15** If the tilt mode is active, then the motor will operate in the following way:  
A short press of the control button (< 0.5 seconds) will operate the blind fully up or down.  
Pressing and holding the control button (>0.5 seconds) will operate the blind while the button is pressed.  
Follow this procedure to disable the 'Tilt-Mode' if it is active:



1. Use the control to adjust the blind to a mid position - stop the blind at the half way position.
2. **PRESS & HOLD** the Up & Down buttons on the control until the blind jogs – then release the buttons.
4. **PRESS & HOLD** the 'my' & Down buttons on the control until the blind jogs – then release the buttons.  
*The 'Tilt-Mode' should now be disabled.*