



ORDER CONTENTS

Check the contents of your order to confirm:

- The blind specification matches what was ordered.
- The number of brackets supplied per blind system is correct.
- The control along with any additional accessories (if ordered) is correct.
- Please report any missing or incorrect items as soon as possible.

PREPARATION BEFORE FITTING

What you will need to fit the blind:



Please take care when unpacking your blind and do not use a knife or any sharp objects when unpacking.

We recommend you fit the battery tube/pack first if selected as the power supply.

POWER SUPPLIES

Somfy Reloadable Battery Tube

Remove the battery tube end cap, insert the batteries (insert the correct way) and secure in place with both end caps screwed tightly on.



Mark and secure the mounting clips where you want the battery tube located (the battery tube can be secured either vertically or horizontally within the window recess).

We recommend the battery tube is secured behind the headrail so it is hidden from view.

Clip the battery tube into the mounting clips.

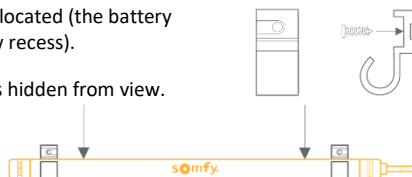

Somfy Li-ion Rechargeable Battery Pack

Mark and secure the mounting clips where you want the battery pack located (the battery pack can be secured either vertically or horizontally within the window recess).

We recommend the battery pack is located behind the headrail so it is hidden from view.

Slide the battery pack into the mounting clips.

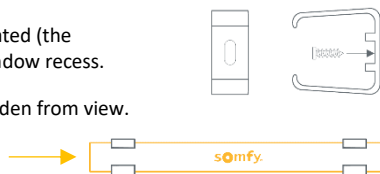

Somfy Plug In Mains Adapter

Plug the mains adapter into the socket outlet and connect the supply cable to the motor cable. Ensure that any loose cable is secured and tidied away safe from the operation of the blind.

Somfy Solar Pack

Follow the instructions provided with the solar panel.

BLIND FITTING

Bracket Marking & Fitting

The brackets are a universal type that can be used for face and top/ceiling mounting.

Ensure that brackets are positioned away from window/door handles or any other obstructions to allow the blind to operate smoothly.

A bracket should sit either side of the rail, 110mm away from the end with remaining brackets equally distributed along the width.

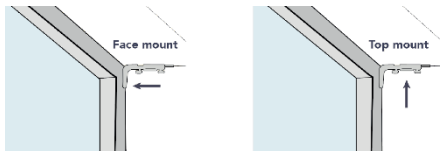

Blind Position

Outside Recess Fitting

Centre your blind in the middle of your window:

- Check measurement 'C' at the same at both sides.
- C is equal to 'A' minus 'B' divided by two.

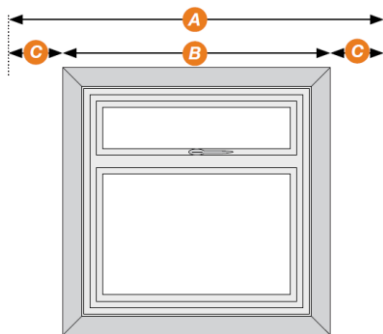

Inside Recess Fitting

- When positioning the brackets, account for the blind to clear window handles.
- Top fix to the window recess or face fix to the window frame.

Hold each bracket in place and mark the hole positions using a pencil.

Fitting the Blind/Headrail

When the brackets have been fitted to the window area, holding the blind up, rest the front ridge of the rail onto the front lip of the bracket. Lift the back of the rail to meet the bracket, push centre of the spring so that it clicks into place securely and release.

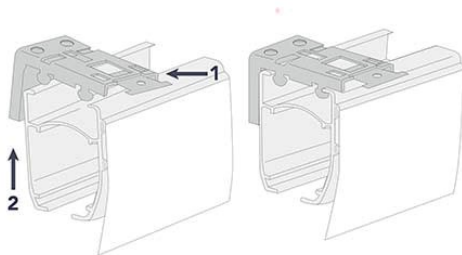

POWER UP THE BLIND

Connect your Somfy power supply to the motor supply cable.

Tidy away any loose supply cable that might get caught in the blind during operation.

The blind will briefly jog indicating the motor is powered up.

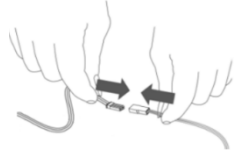

BLIND OPERATION – CONTROL ORDERED WITH THE BLIND

Note: If you ordered a control with your blind it will arrive paired to the motor with the upper and lower stopping positions pre-set. The blind can be operated once the power supply has been connected to the blind motor.

Single Channel Controls

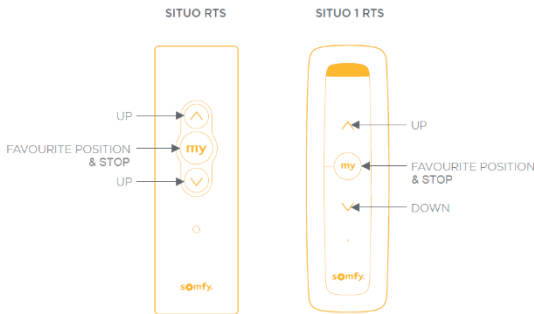

Multi Channel Control

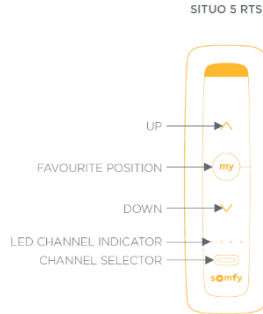

Note: Other Somfy controls and wall switches will operate the same way based on the control buttons.

BLIND OPERATION – NO CONTROL ORDERED WITH THE BLIND

Note: If you didn't order a control with your blind, then the control you already have will require pairing to the blind motor. Once the pairing process has been completed, the blind can be operated with your control.

Single Channel Control Pairing Process

(after powering up the motor)

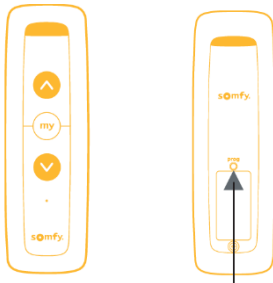

Briefly Press & Release the Up & Down Buttons – the blind will jog.

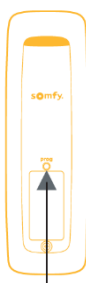

Briefly Press & Release the program button on the back of the control – the blind will jog.

Multi Channel Control Pairing Process

(after powering up the motor)



Select the desired channel using the channel selector button

CHANNEL
SELECTOR



Briefly Press & Release the Up & Down Buttons – the blind will jog.

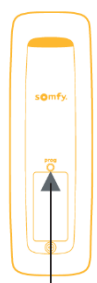

Briefly Press & Release the program button on the back of the control – the blind will jog.

Once the pairing process has been completed, the blind can be operated.

ADJUSTING THE UPPER & LOWER STOP POSITIONS

Adjust the lower stop position

STEP 1 Press down on the control and allow the blind to stop at the existing stop point (the blind must stop on its own accord for this to work).	
STEP 2 PRESS & HOLD both the UP & DOWN buttons together until the blind jogs.	
STEP 3 Adjust the blind to the new lower stop position using the Up/Down buttons.	
STEP 4 PRESS & HOLD the 'my' button until the blind jogs up/down - then release. The new lower stop position has been set.	

Adjust the upper stop position

STEP 1 Press up on the control and allow the blind to stop at the existing stop point (the blind must stop on its own accord for this to work).	
STEP 2 PRESS & HOLD both the UP & DOWN buttons together until the blind jogs.	
STEP 3 Adjust the blind to the new upper stop position using the Up/Down buttons.	
STEP 4 Press & hold the 'my' button until the blind jogs briefly up/down - then release. The new upper stop position has been set.	

SET & DELETE A 'my' POSITION

SET A 'MY' POSITION 1. Operate the blind to the desired 'my' position (e.g. half way down). 2 PRESS & HOLD the 'my' button until the blind jogs. The 'my' position is set.	
DELETE A 'MY' POSITION 1. Adjust the blind to the current 'my' position. 2 Press and hold the 'my' button until the blind jogs. The 'my' position has been deleted.	
USING THE 'MY' POSITION ! The blind must be stationary. Briefly press the 'my' button and the blind will operate to the 'my' position.	

TROUBLESHOOTING

Observations	Possible Causes	Solution
The blind does not respond	Power supply issue	Check battery pack, mains adapter
	The control battery is low	Replace the battery
	The control is not paired	Pair the control to the motor or carry out a motor reset
The blind doesn't operate to the up or down position	Power supply issue	Check battery pack, mains adapter
	The stop positions require adjusting	Reprogram the stop position
The blind only operates when holding the control button	The motor has not been programmed correctly	Carry out a motor reset + reprogram procedure

Motor Reset

If you are programming multiple blinds, we recommend you disconnect the power to all other blinds in signal range. Ensure the blind you are programming has the power supply connected to the motor.

If using a Somfy multi-channel control, ensure the desired channel is selected prior to starting the programming process.



Motor reset

1 The motor is located inside the headrail - the reset button is located under the white flap next to where the supply cable and aerial exit the motor.

PRESS & HOLD the reset button (push the end of the white flap) on the motor until the blind jogs three times.

Don't release the button until the motor has completed the cycle of three separate jogs (*the motor should jog after: 2-3 secs, 4-5 secs & 10secs*).

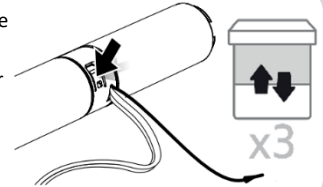

Start the programming process

2 Start the programming process by **BRIEFLY PRESSING** the control Up & Down buttons together - the blind will briefly jog. The control is now temporarily paired to the motor and you have 10 mins to complete the programming process.



Checking/correcting the blind direction

3 **BRIEFLY PRESS & RELEASE** the Down button on the control. If the blind operates down, the direction is correct – go to the next step. If the blind operates up, **PRESS & HOLD** the 'my' button until the blind jogs to reverse the direction.

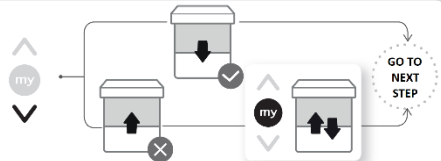

Recording the upper & lower stop positions

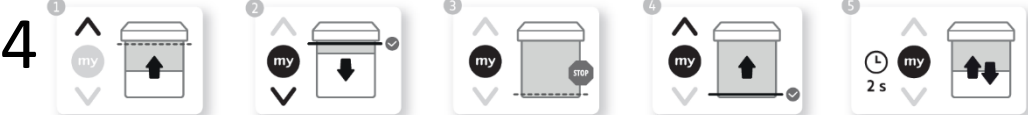

1. Use the control to adjust the blind to the upper stop position.
2. **BRIEFLY PRESS & RELEASE** the 'my' & Down buttons on the control – the blind will operate down.
3. **BRIEFLY PRESS** the 'my' button once the blind reaches the lower stop position.
Fine tune to the exact lower stop position if required with the Up & Down buttons.
4. **BRIEFLY PRESS & RELEASE** the 'my' & Up buttons on the control – the blind will operate up and stop at the upper stop position previously set.
5. Record the stopping positions by **PRESSING & HOLDING** the 'my' button until the blind jogs.

Pairing the control & completing the programming process

5 **BRIEFLY PRESS & RELEASE** the program button on the control – the blind will jog. The programming process is complete and the blind motor is programmed.

The blind will now operate with a brief press of the Up or Down buttons and automatically stop at the preset stop positions.

