

Before you begin

This procedure will only work if the motor is programmed correctly and operating in use mode.

When the motor is programmed correctly and operating in user mode, the blind will:

- Operate with a brief press of the Up or Down buttons.
- The blind will operate to the preset upper or lowers stop position and automatically stop.
- You do not have to hold the Up or Down buttons to operate the blind.

If you have to hold the Up/Down buttons to operate the blind, then we recommend you carry out a reset & reprogram procedure on the blind motor.

Activate sleep mode

- 1 PRESS & HOLD** the button on the motor head until the blind jogs:
The motor should jog after: 2-3 secs
Release the button as soon as the motor completes the first jog cycle.

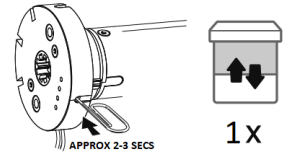

Activate sleep mode

- 2 BRIEFLY PRESS & RELEASE** the button on the motor head:
The motor will briefly jog twice
The motor is now in sleep mode and will not respond to any control commands.
Test with the control – the motor should not respond to any control commands.

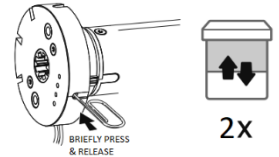

Disable sleep mode

- 3 BRIEFLY PRESS & RELEASE** the button on the motor head:
The motor will briefly jog
Sleep mode has now been disabled and the motor will respond to control commands.

